

*Steel Goat
Milking Stand
With Ramp*

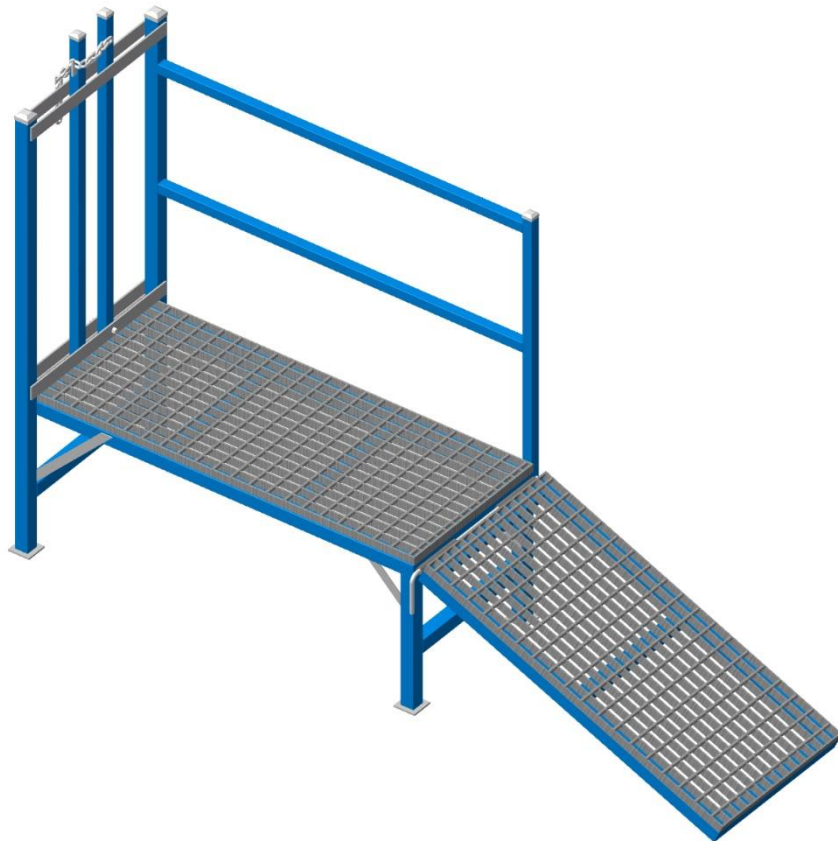

Kurraglen Industries
PO Box 215
Gulgong, NSW, 2852
Australia

<https://www.kurraglenindustries.com.au>

sales@kurraglenindustries.com.au

<https://www.facebook.com/kurraglen/>



Goat Milking Stand with Ramp

There are many goat milking stand plans available which are made from wood (timber) but if you build one from steel (metal), it will not rot or become weak or loose as timber tends to.

Tools required include a welder, either stick or mig, G clamps or welding clamps, tape measure, angle grinder for cutting and cleaning up welds, electric drill and a square. You may buy lengths of steel and cut it to the correct sizes if you have either an angle grinder or electric bandsaw or you may choose to have the steel cut for you from a local steel supplier. One thing that will make your job a lot easier is to construct a pair of welding trestles as shown on our website (www.kurraglenindustries.com.au). The plans for the welding trestles are free.

To make the best use out of your lengths of steel, we have a free-to-use Cutting List Optimiser on our website. Visit <https://www.kurraglenindustries.com.au/linear-cutting-list-calculator.htm>

The following steel and materials are required to build the goat milking stand:

40x40x2.0 SHS – 2 lengths of 8 metre	65x5 flat – 0.3 metres
30x30x2.0 SHS – 3 metres	40x40 square caps – 2
25x25x2.0 SHS – 2.4 metres	30x30 square caps – 3
40x5 flat bar – 2.5 metres	Chain 5 or 6mm diameter. Approx. 500mm long
25x3 flat bar – 1.5 metres	12mm round bar – 650mm
15nb medium wall pipe – 300mm	

Cutting List for the 8 foot hay feeder				
Item No	Quantity	Material	Size (mm)	Notes
1	2	40x40x2.0 SHS	1200	45 degree mitre both ends
2	2	40x40x2.0 SHS	500	45 degree mitre both ends
3	2	40x40x2.0 SHS	420	
4	2	40x40x2.0 SHS	400	
5	2	40x40x2.0 SHS	420	
6	2	40x40x2.0 SHS	1320	
7	4	40x5.0 flat	560	
8	4	25x3.0 flat	330	45 degree mitre both ends
9	4	65x5.0 flat	65	
10	2	30x30x2.0 SHS	980	
11	1	30x30x2.0 SHS	800	
12	2	25x25x2.0 SHS	1125	
13	2	40x40x2.0 SHS	1000	45 degree mitre both ends
14	2	40x40x2.0 SHS	500	45 degree mitre both ends
15	1	40x40x2.0 SHS	420	

1. Begin by cutting all of the steel as indicated in the cutting list. Label each with the item number on it using a marking pen and set aside. Take note of the mitre cuts for the SHS to ensure that they are cut the correct way.

2. Tack weld the main floor frame together as shown in diagram 1. Check that the frame is square and fully weld.

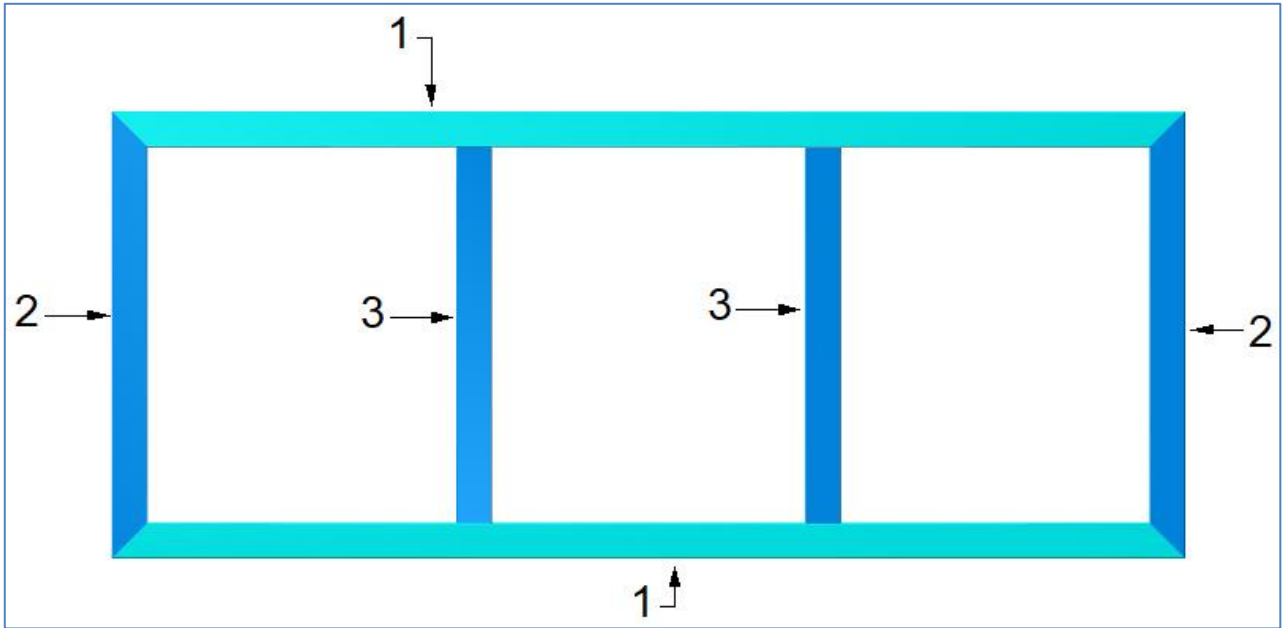

Diagram 1

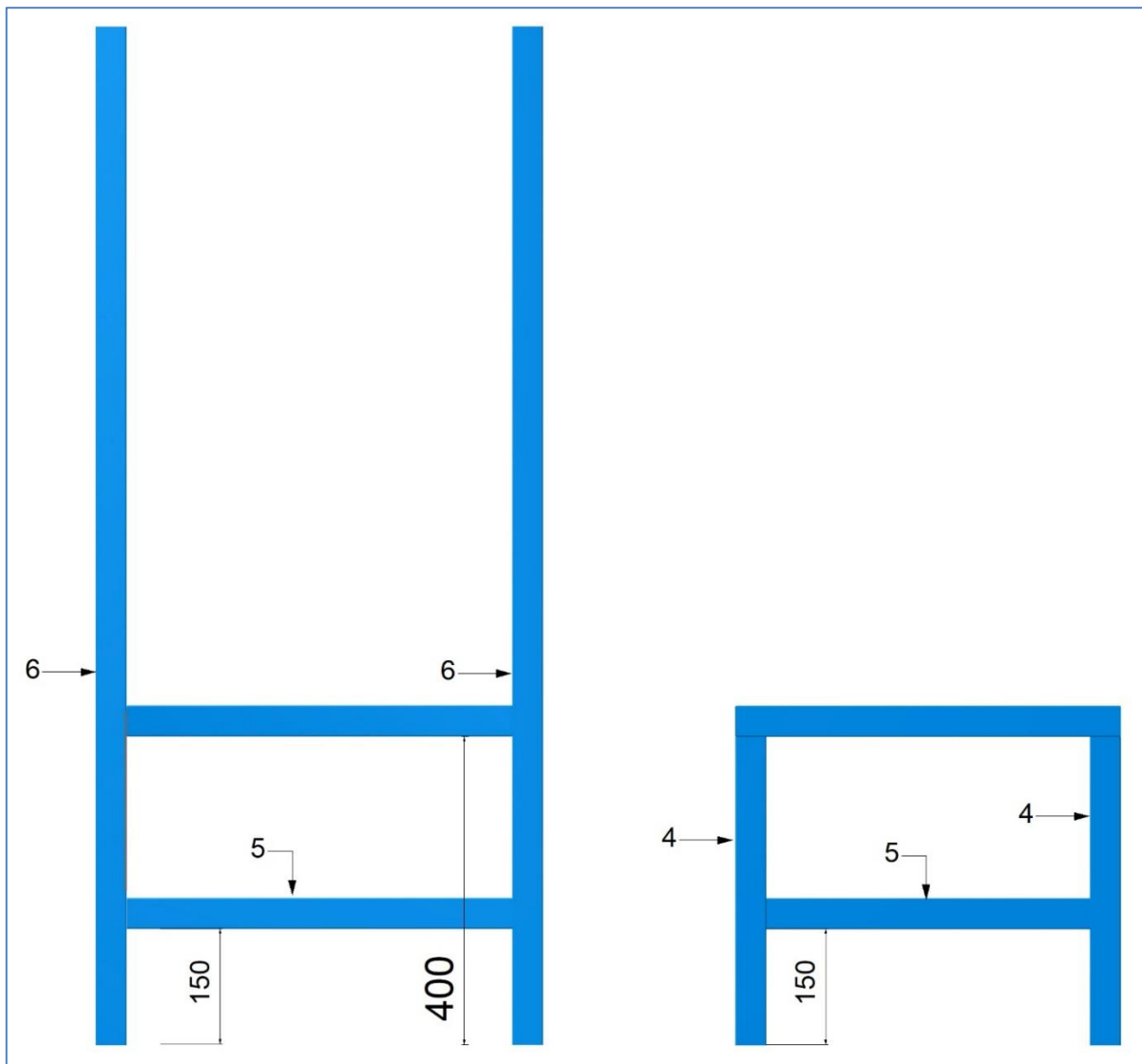

Diagram 2

3. Tack weld items 4, 5, 6, 7, 8 and 9 as shown in diagrams 2 and 3. The top of items 7 are located 25mm down from the tops of items 6. Check that the frame is square and fully weld.

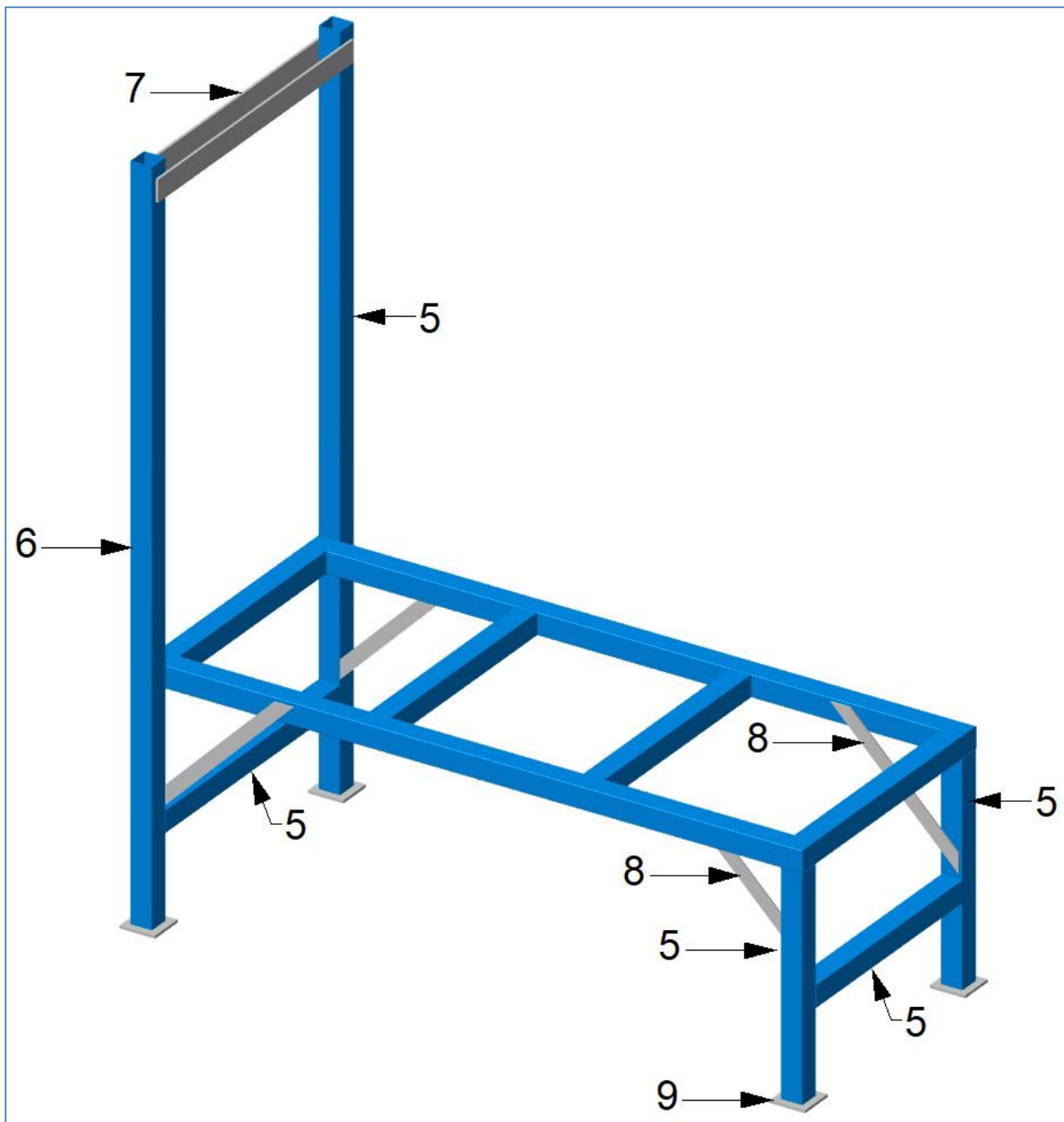

Diagram 3

4. Drill 11mm holes in the remaining items 7. Refer to diagram 4.

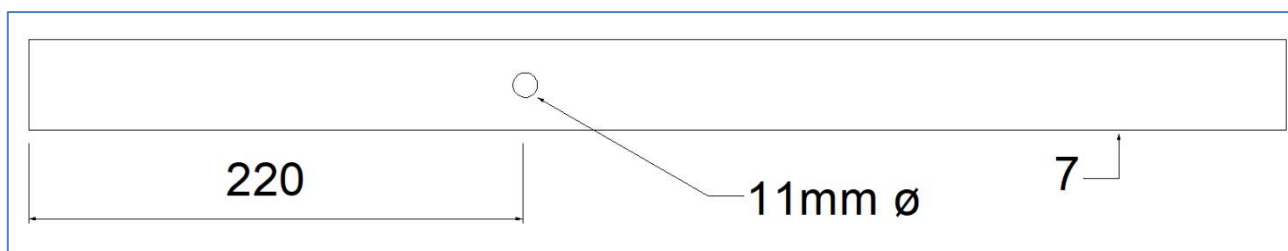

Diagram 4

- Weld one of items 10 to the upper and lower flat bar (items 7) as shown in diagram 5. This is the fixed side of the head bails. Diagram 5 is viewed from the head bail end of the stand.
- Drill an 11mm diameter hole in one of items 10. The centre of the hole should be 20mm in from the lower end. Install the item 10 with the hole in it as shown in diagram 5. Secure this in place with a M10x65 zinc plated bolt and nyloc nut.

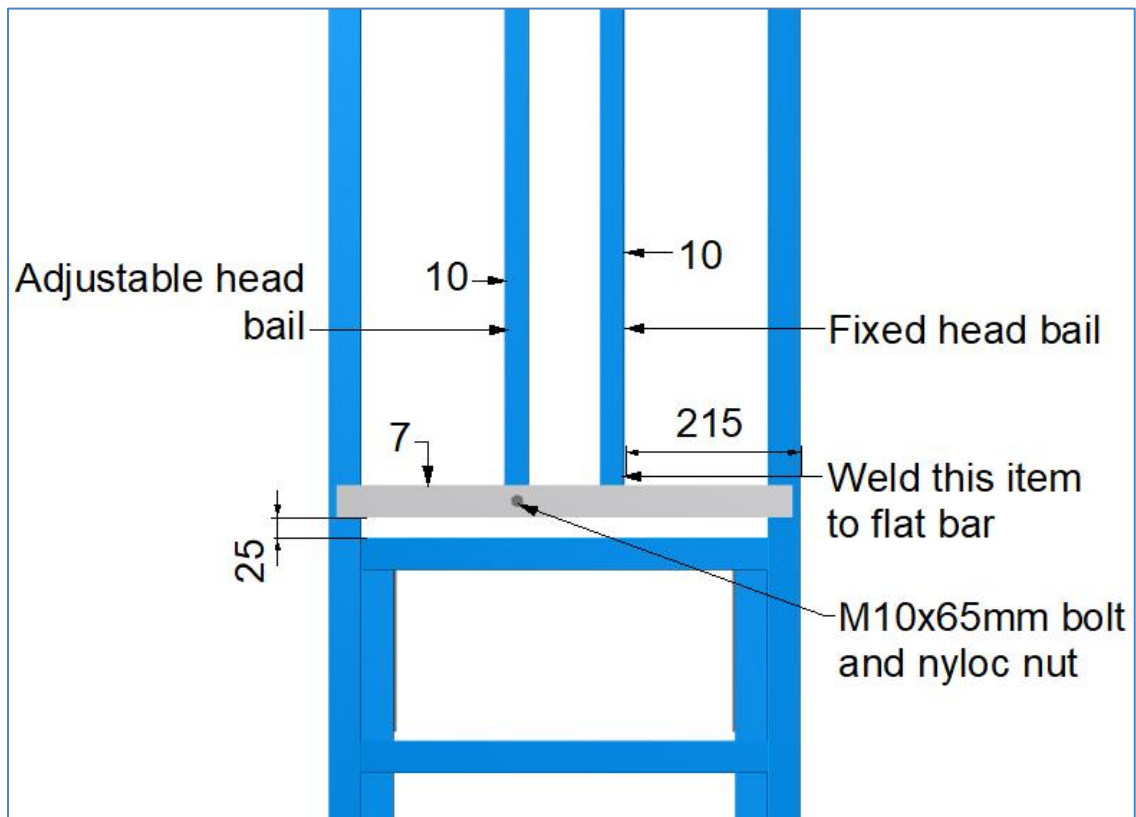

Diagram 5

- Cut a length of 25x5mm flat bar 10mm long and an 8mm round bar 50mm long. Weld these in place as shown in diagram 6. The bottom edge of the flat and round bar should be approximately 45mm above items 7. Weld a 500mm length of 5 or 6mm gal chain in place. Refer to diagram 6.

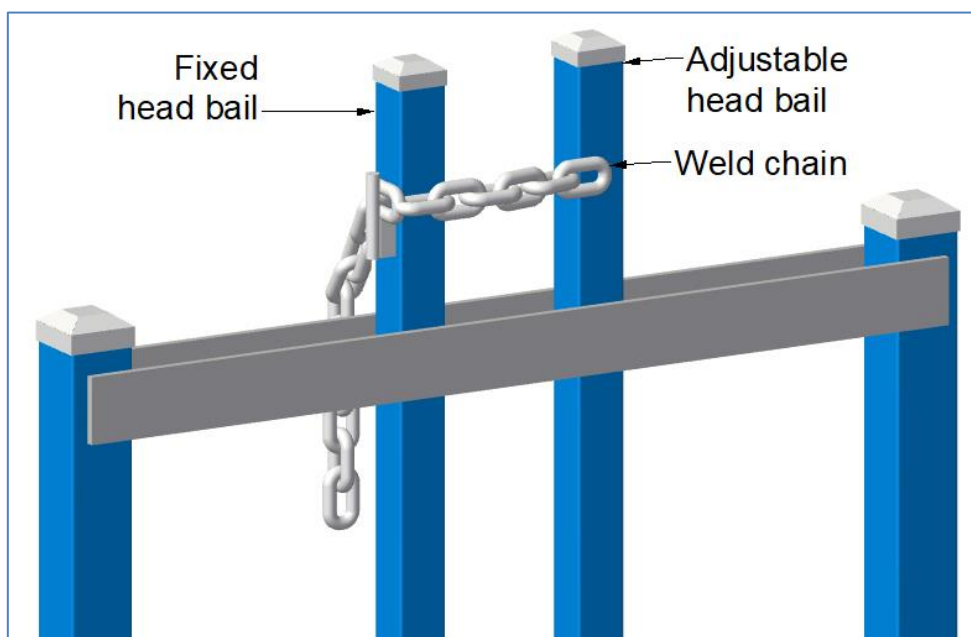

Diagram 6

8. Weld items 11 and 12 in place as shown in diagram 7.

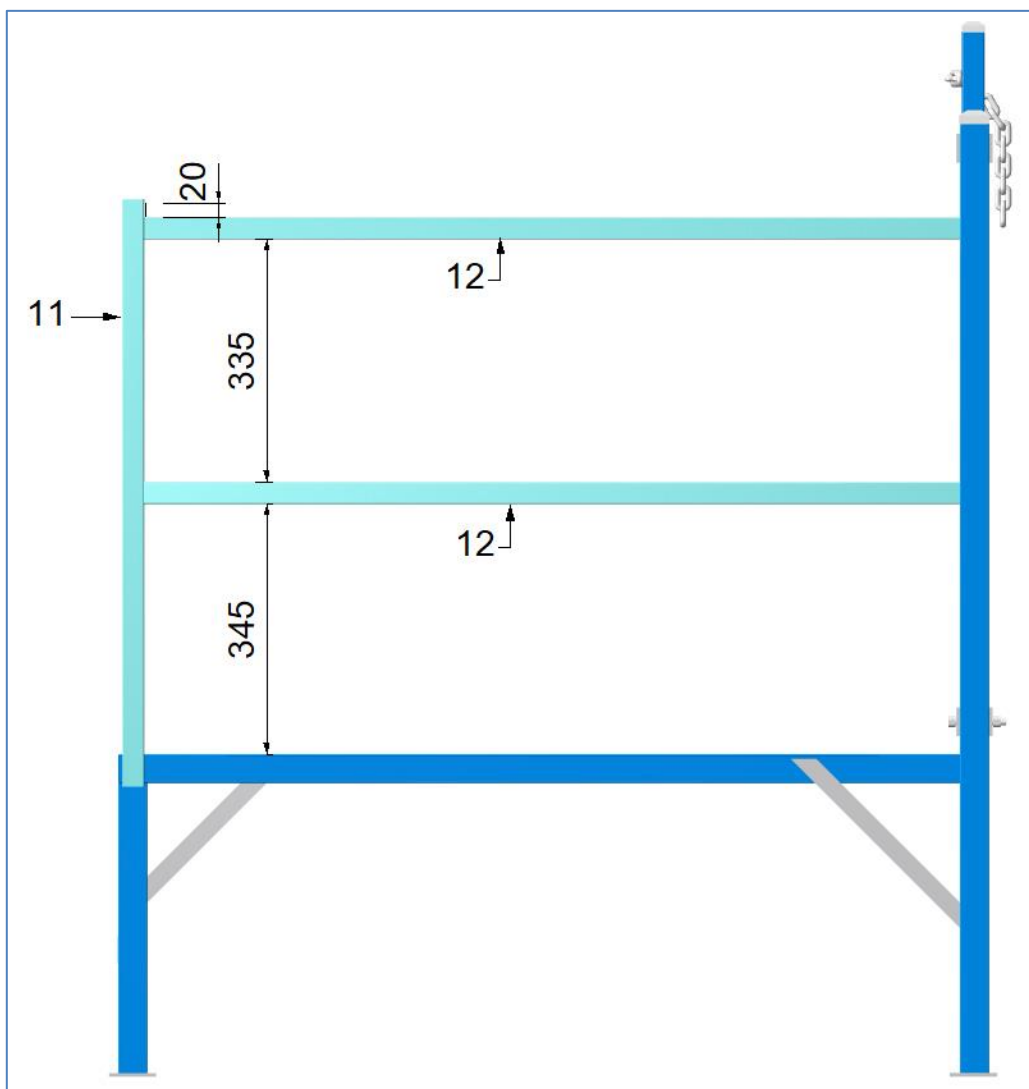

Diagram 7

9. Tack weld items 13, 14 and 15 together. Check that the frame is square and fully weld.

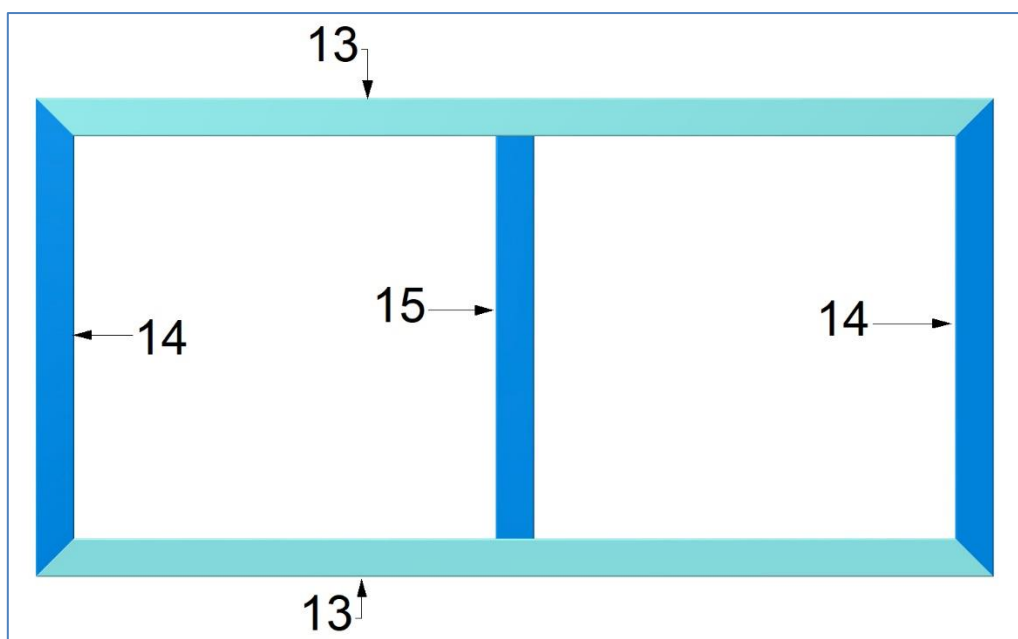

Diagram 8

10. Cut four lengths of 15nb medium wall pipe each 75mm long. Cut one length of 12mm round bar 650mm long. Bend the round bar at a 90 degree angle 150mm in from the end.

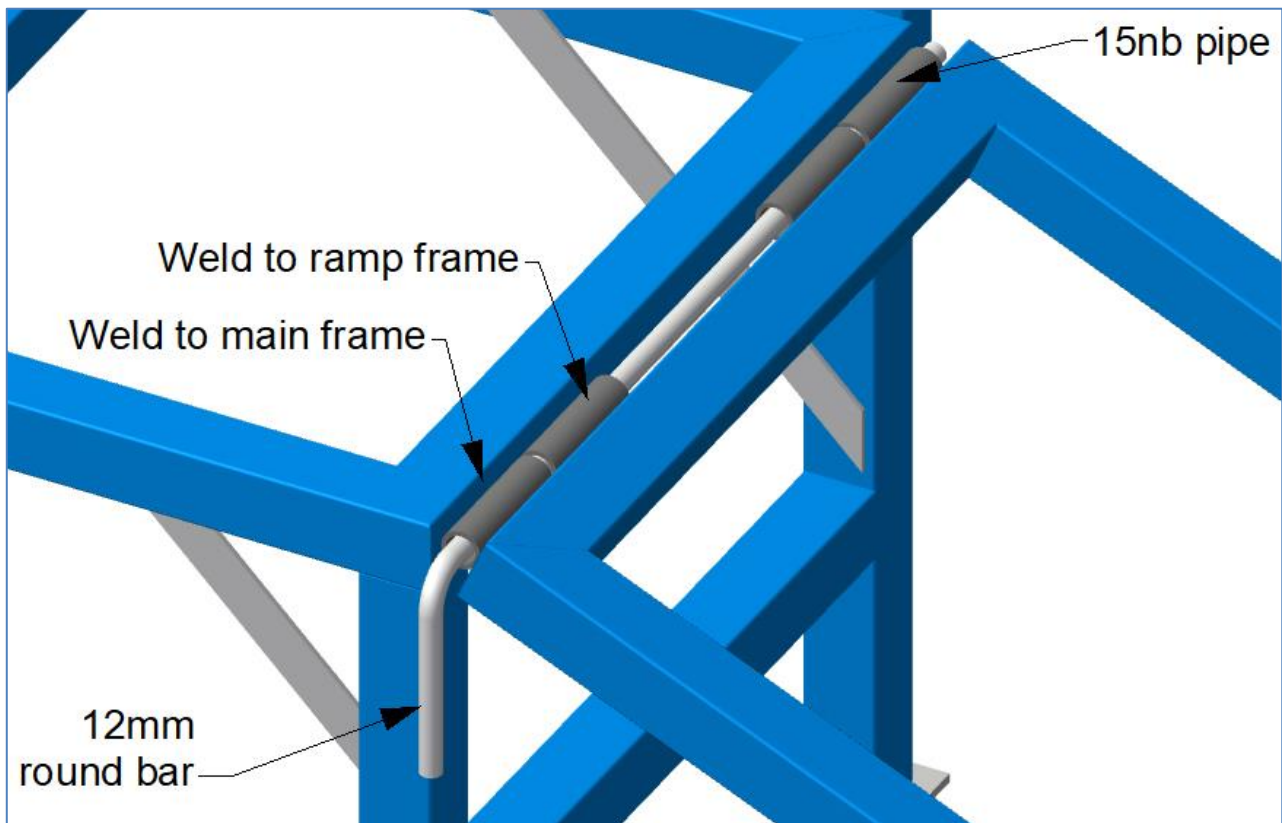

Diagram 9

11. Tack weld the 15nb pipe in place. The two outer lengths are welded to the main frame whilst the two inner lengths are welded to the ramp frame. Ensure that the tops of the frames are level with each other at the top and that the 12mm round bar will slide into the pieces of pipe, then fully weld the pipe in place. Refer to diagram 9.
12. Clean any welds using a grinding disc or flap disc and paint as required.
13. Install your choice of flooring. This can be exterior grade plywood, steel grating or expanded metal mesh.

Proud of your project? Email us the photos of your equipment or yards that you have made from our books and we will put them up on our website for others to admire. You can even be in the photo if you would like to be. Be sure that you include your name, where you are from and a brief description. Please make sure that the photos are of good quality, in jpg (jpeg) or png format, at least 72 dpi and at least 900 pixels by 600 pixels. Email your photos to: projects@kurraglenindustries.com.au